

GO-GOWANUS!

UNITING COMMUNITY & INFRASTRUCTURE THROUGH PUBLIC SPACE



Section Maps of Gowanus Canal



HAVE YOU TRIED DRINKING THE CANAL WATER?
YEAH... IT TASTES GOOD!

OY! THERE ARE FISH DOWN HERE!

LOOK MARTHA... IT'S A GO-BOT!!

BY INHABITING THE CANAL, PEOPLE GAIN ACCESS TO A UNIQUE AND SPECIAL PART OF NEW YORK CITY.

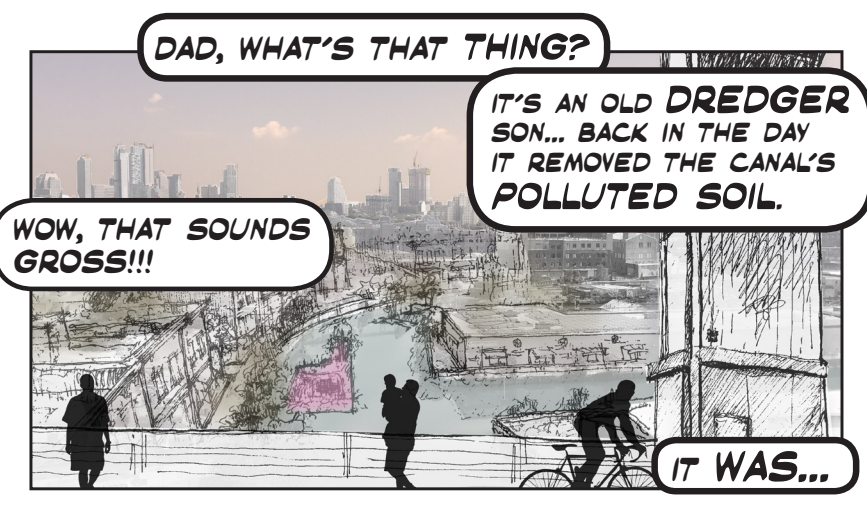

DAD, WHAT'S THAT THING?
IT'S AN OLD DREDGER SON... BACK IN THE DAY IT REMOVED THE CANAL'S POLLUTED SOIL.
WOW, THAT SOUNDS GROSS!!!
IT WAS...



DEAD END STREETS ACTIVATED BY DOCKED GO-BOT.

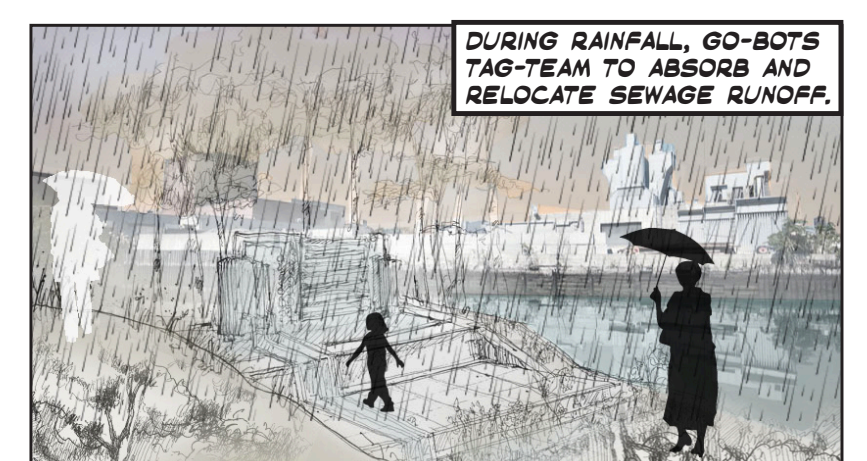

DURING RAINFALL, GO-BOTS TAG-TEAM TO ABSORB AND RELOCATE SEWAGE RUNOFF.

STATEMENT OF INTENT

The core urban problem of Gowanus is neither only social or environmental, but the relationship between the two. The division between the people of Gowanus and the neighborhood's historical identity as a place of industrial production and infrastructure has led to an absence of knowledge and lack of environmental awareness.

We believe people should be given the opportunity to have a better understanding of how their city works, the environment and their impact on it.

The Gowanus canal is the neighborhood's most central public space geographically and programmatically. It is the lifeline for manufacturers and a site for storm water runoff. Yet, the residential community of Gowanus remains largely detached from this vital axis.

An often attempted way to strengthen "community" in many New York City neighborhoods is to include mainstream non-local entertainment-based programs at the exclusion of others and often what makes a neighborhood special. This project takes a stance against such "Disneyfication" and instead embraces the local.

We believe coexistence of the general public and the city's water infrastructure is needed. By embracing the history of Gowanus and uniting it with public spaces that actively service the canal and the greater city, a stronger and more holistic community will develop.

PUBLIC SPACE - THE "GO-BOTS"

The infrastructural role and environmental conditions of the canal are made visible to the public through six floating autonomous water-cleaning public parks--called, "GO-BOTS"--and one Field Station that serves as their primary docking point, waste remediation tank and the community's building center.

During dry weather, the GO-BOTS perform three key canal cleaning tasks--dredging, garbage collecting, and water purification. During rainfall they divide into teams of three to absorb and relocate 71% of the storm water runoff from CSO outfalls RH-034 and OH-007 to remediation tanks below the Field Station.

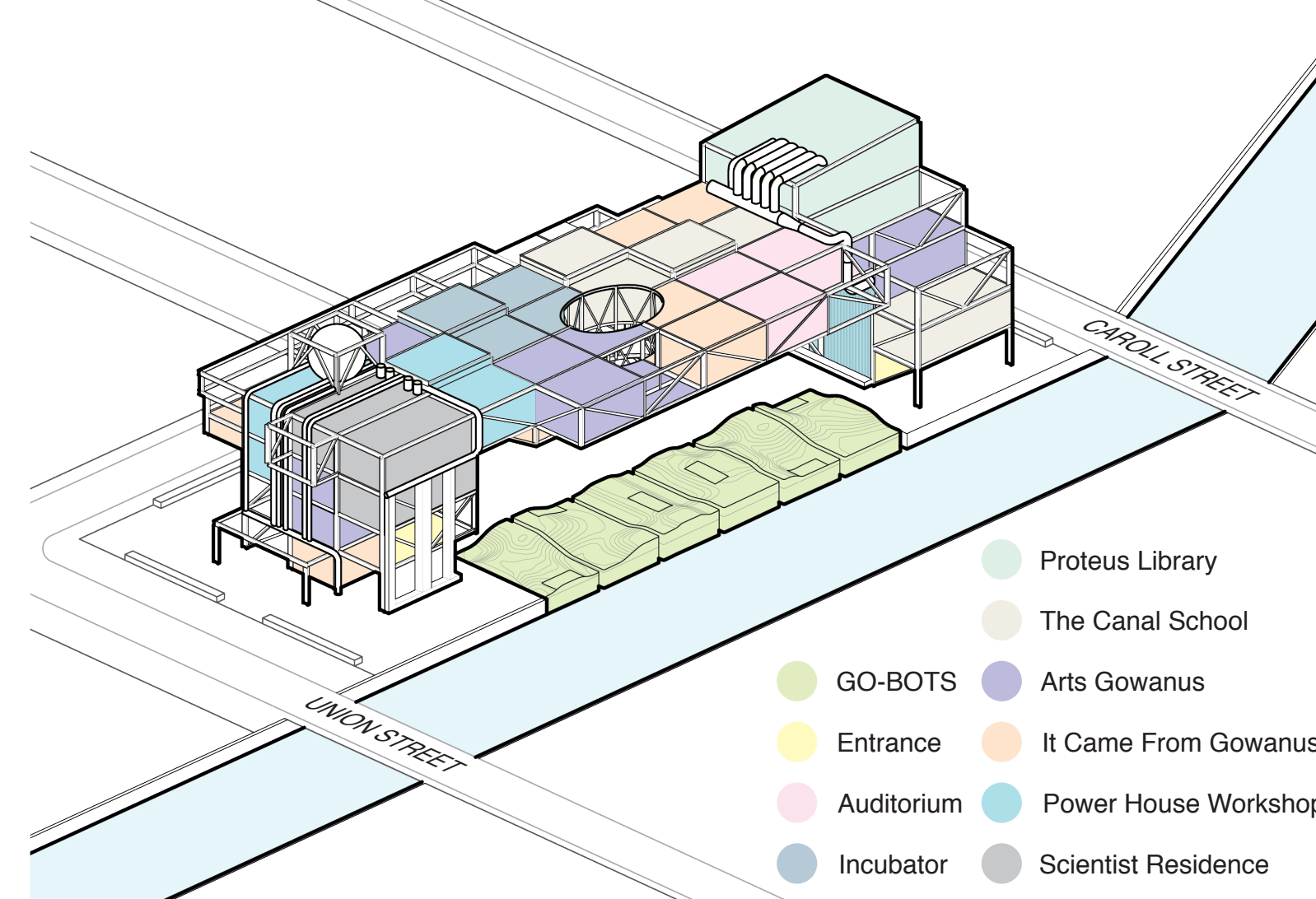

- Proteus Library
- The Canal School
- GO-BOTS
- Entrance
- Auditorium
- Incubator
- Arts Gowanus
- It Came From Gowanus
- Power House Workshop
- Scientist Residence

THE FIELD STATION

The Field Station is an active repository. It houses entertainment programs, education and environmental programs. It is a piece of civic infrastructure that continually educates by collecting and displaying canal waste (contaminated soil, trash and storm water) gathered by the GO-BOTS. Its architectural language--derived from industrial storage racks of nearby manufacturers--is an open framework that unites its different activities.

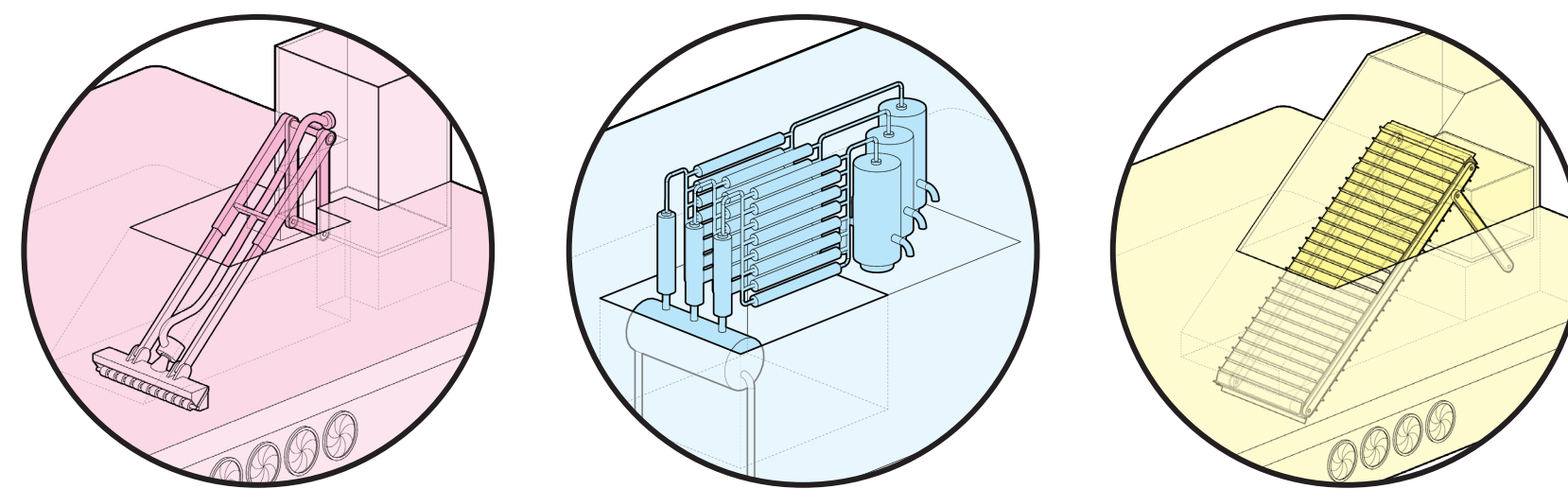
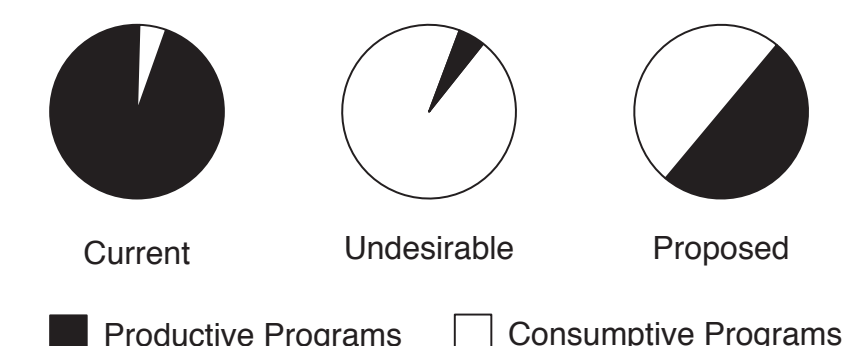

THE DREDGERS THE LIFE SAVERS THE GARBAGE EATERS

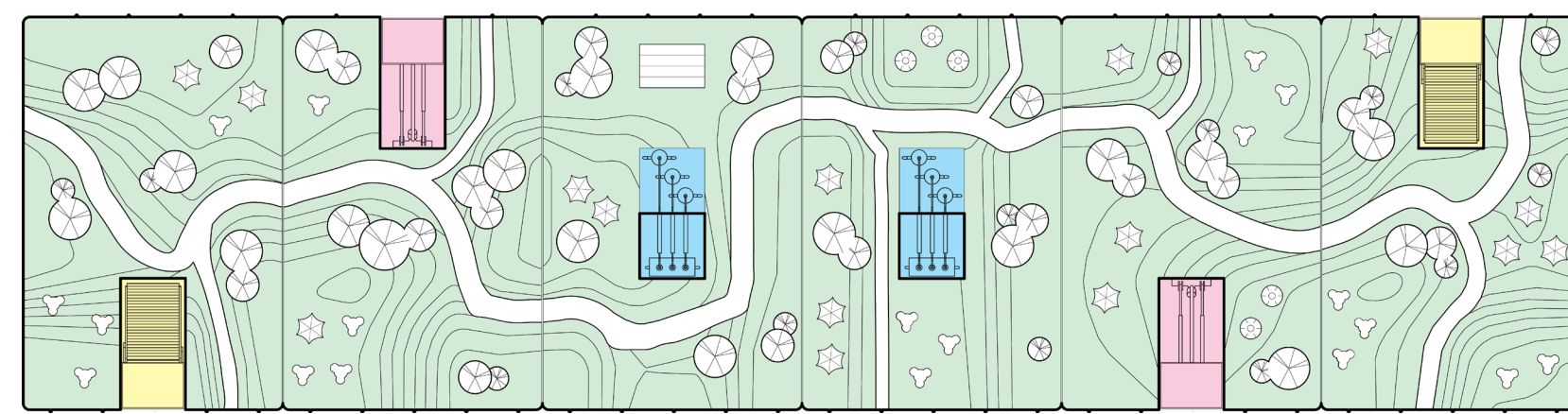

COMBINED REMEDIATION SUPER PARK

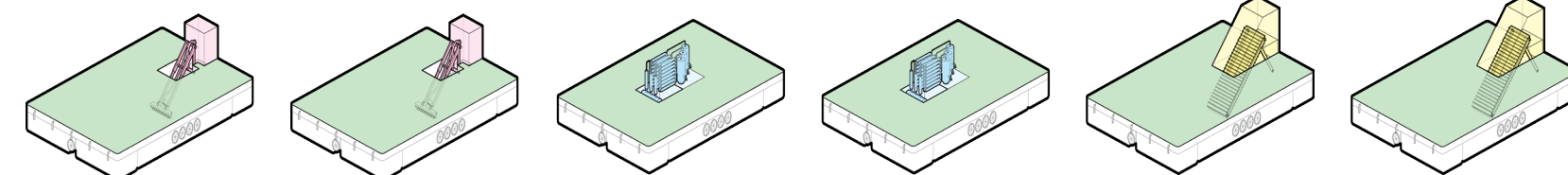

"GO-BOTS" - SIX CANAL CLEANING PUBLIC PARKS

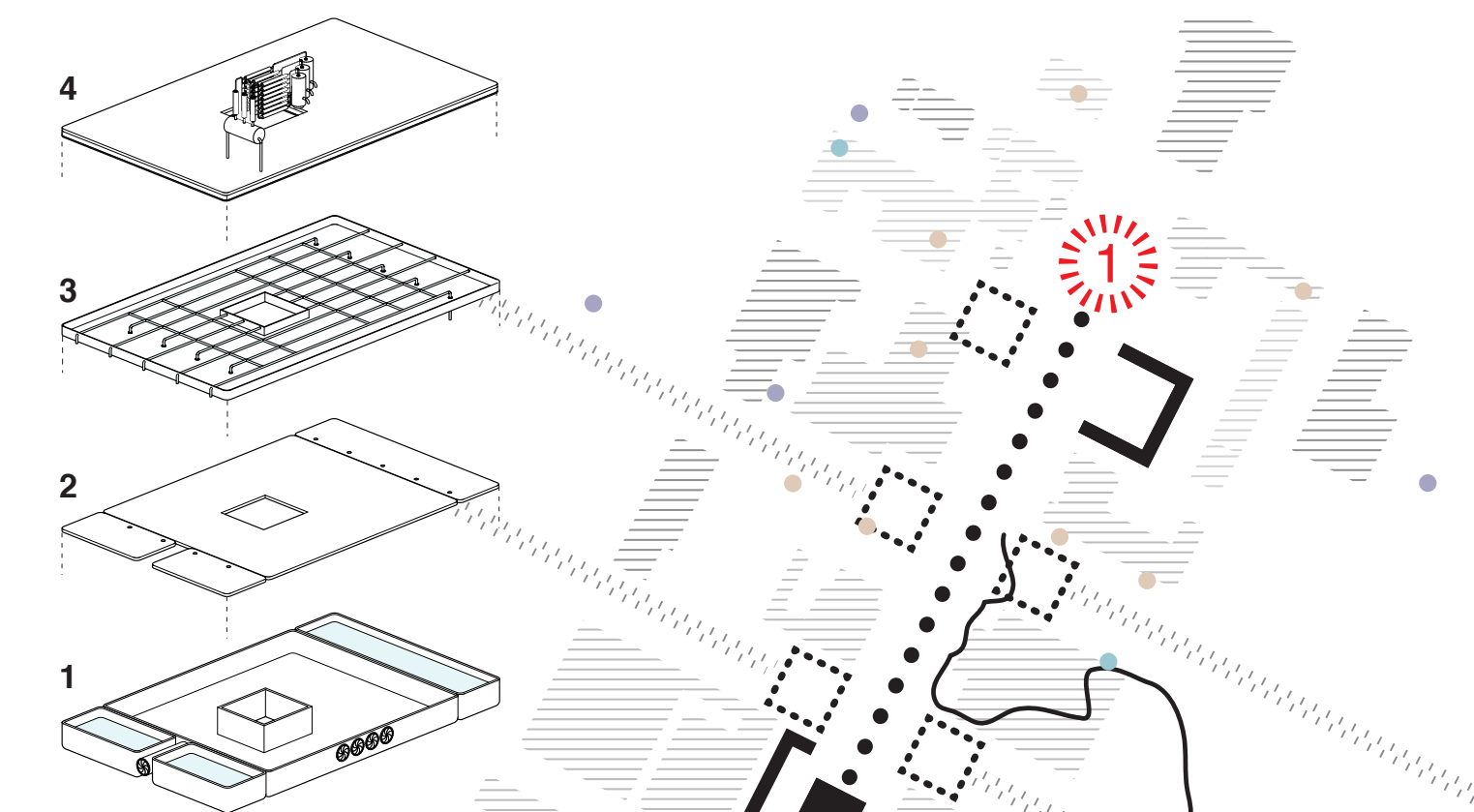

1. Reversible Water Tanks (canal water or CSO water)
2. Enclosure
3. Irrigating System
4. Green Assembly

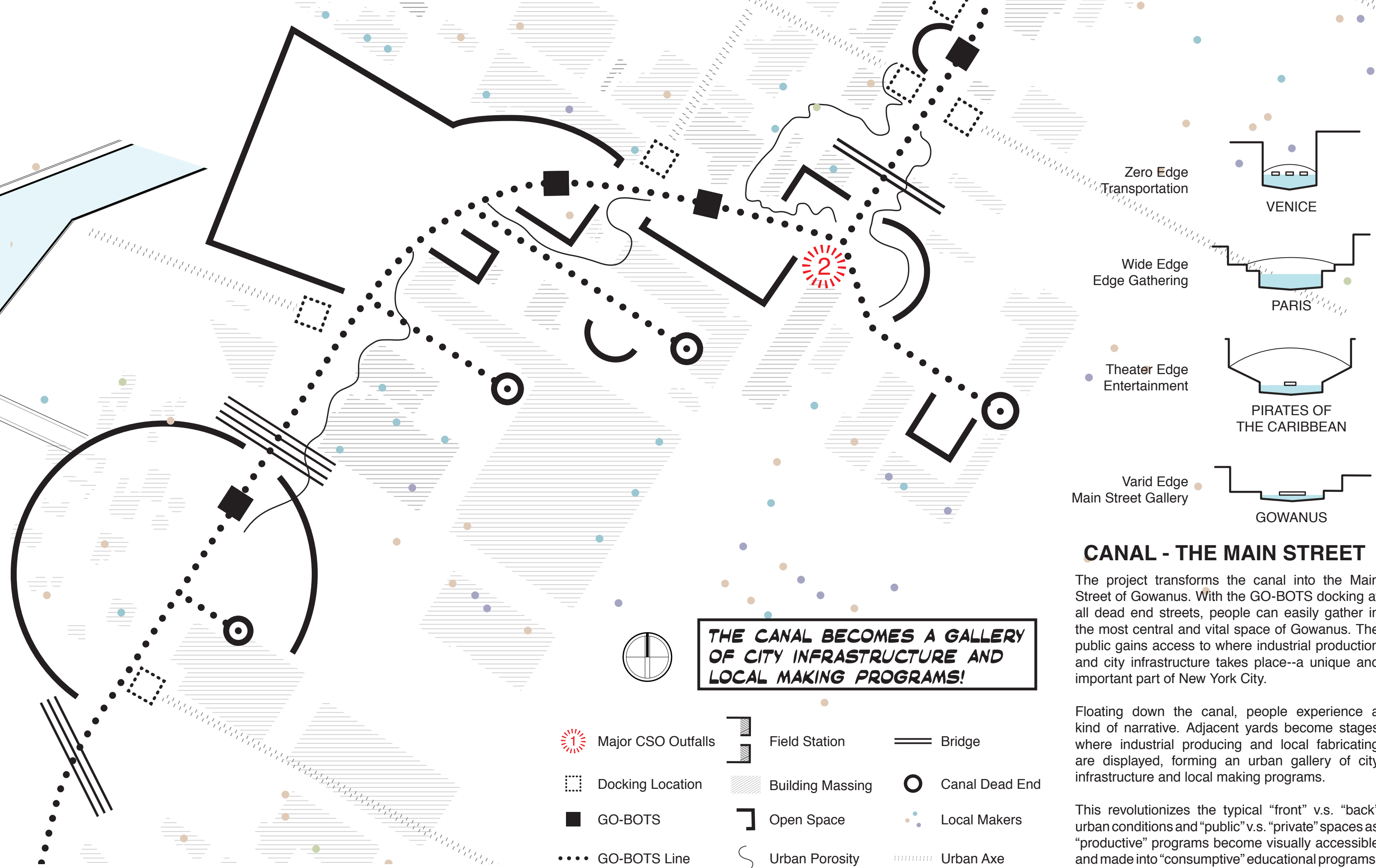

THE CANAL BECOMES A GALLERY OF CITY INFRASTRUCTURE AND LOCAL MAKING PROGRAMS!

- Major CSO Outfalls
- Docking Location
- GO-BOTS
- GO-BOTS Line
- Field Station
- Building Massing
- Open Space
- Urban Porosity
- Bridge
- Canal Dead End
- Local Makers
- Urban Axe

CANAL - THE MAIN STREET

The project transforms the canal into the Main Street of Gowanus. With the GO-BOTS docking at all dead end streets, people can easily gather in the most central and vital space of Gowanus. The public gains access to where industrial production and city infrastructure takes place--a unique and important part of New York City.

Floating down the canal, people experience a kind of narrative. Adjacent yards become stages where industrial producing and local fabricating are displayed, forming an urban gallery of city infrastructure and local making programs.

This revolutionizes the typical "front" v.s. "back" urban conditions and "public" v.s. "private" spaces as "productive" programs become visually accessible and made into "consumptive" educational programs.



RESIDENTIAL TYPOLOGY



INDUSTRIAL TYPOLOGY



RESIDENTIAL PATTERN



INDUSTRIAL PATTERN

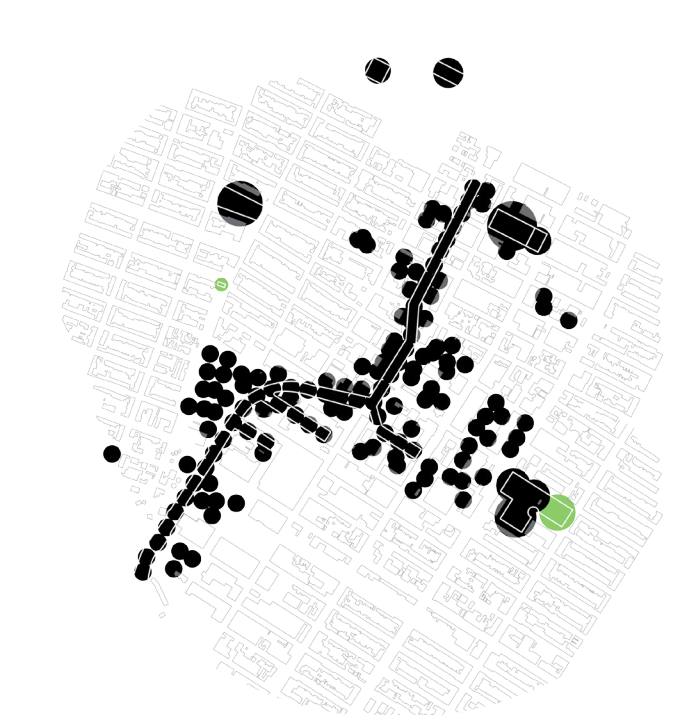

EXISTING "GREEN" PUBLIC SPACE

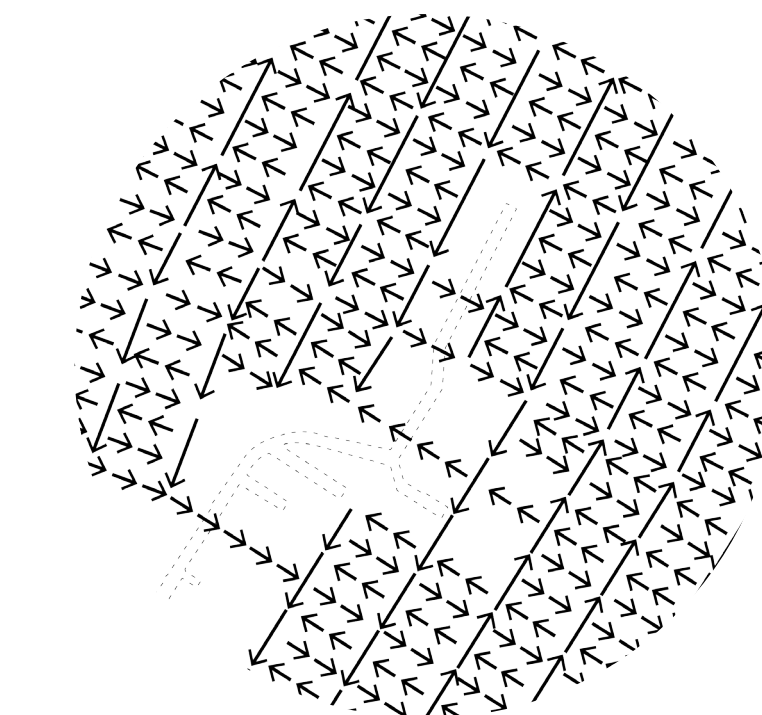

PEDESTRIAN MOVEMENT

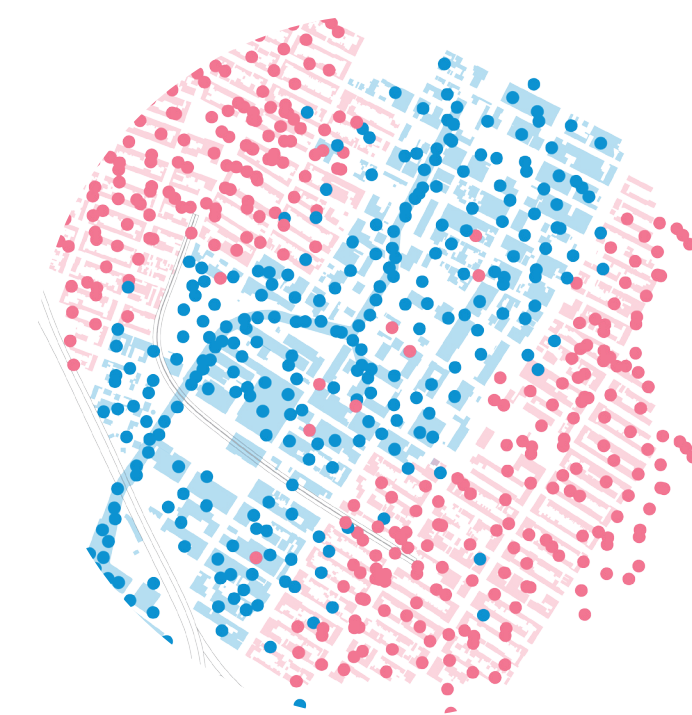

CURRENT LAND-USE

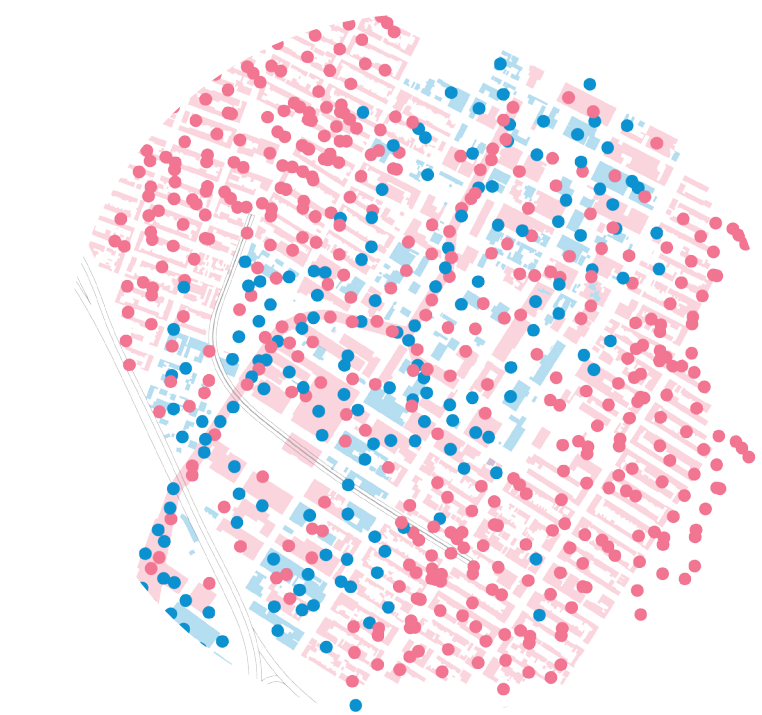

PROPOSED LAND-USE